

## SC2 (NUTRING)-PU

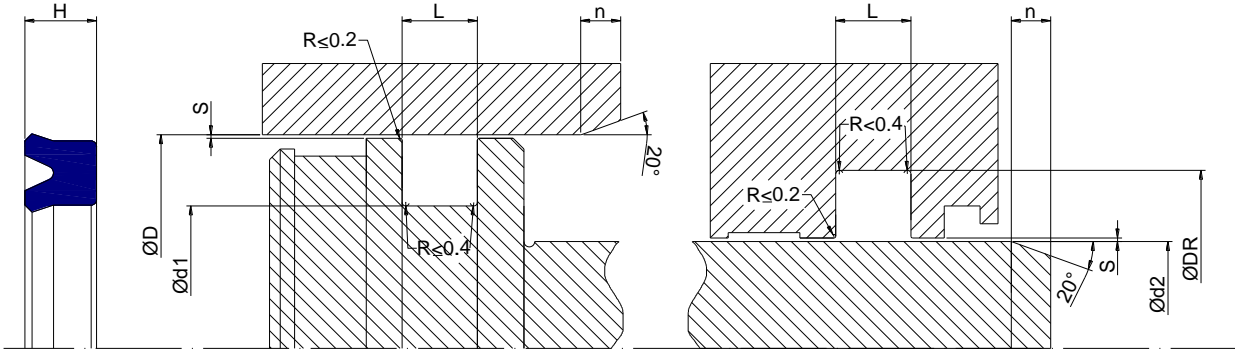

### ÜRÜN TANITIMI

Üretim programımızda yer almakta olan SC2 nutringler, simetrik dudak yapısı sayesinde hem piston, hem de rod uygulamalarında tek etkili olarak kullanılabilir. Standart olarak PU (92 Shore A)' dan üretilmektedir.

### AVANTAJLAR

- \* Statik ve dinamik sızdırmazlık özelliği
- \* Ölçü çeşitliliği seçeneğinin olması
- \* Parçalı piston başı gerektirmemesi,

\* verilen değerler maksimum değerlerdir ve standart ürün içindir.

ÇALIŞMA SICAKLIKLARI			Ra	
HİDROLİK YAĞLAR(HL-HLP) DIN51524	-30	100	Ød-Ød	≤0,4 µm
HFA	5	50	Ød-Ød	≤1,6 µm
HFB	5	50	L	≤3,2 µm
HFC	-30	40		
HFD	-	-		
SU	5	40		
HETG(KANOLA YAĞI)	-30	80		
HEES(SENTETİK ES)	-30	60		≤5*
HEPG(GLİKOL)	-30	40	150	0,3
MİNERAL GRESLER	-30	100	250	0,2
ÇALIŞMA BASINCI	350	BAR	350	0,15
KAYMA HIZI	0,5	M/SN		

### MONTAJ BİLGİLERİ

- \*Dudak kanalı basınç hattına bakmalıdır.
- \*Kapalı tip yuvalara montaj yapılamıyor ise parçalı piston uygulamasına geçilebilir veya özel montaj aparatı kullanılabilir.
- \*Montaj öncesi, keçe mutlaka sistem yağı ile yağlanmalıdır.

### KULLANIM ALANLARI

- İş makineleri,
- forklift ve krikolar,
- enjeksiyon tezgahları itici ve yan kolları,

<b>SC KOD</b>	<b>Ød</b>	<b>ØD</b>	<b>H</b>
SC-2	3	10	6
SC-2	4	10	4
SC-2	4	10	6
SC-2	5	10	5
SC-2	5	10	7
SC-2	5	11	4
SC-2	5	11	5
SC-2	5	11	7
SC-2	5	12	5
SC-2	6	10	3
SC-2	6	12	4
SC-2	6	12	6
SC-2	6	12	7
SC-2	6	12	8
SC-2	6	15	5
SC-2	6	15	8
SC-2	6	16	6
SC-2	6	16	7
SC-2	6	18	8
SC-2	6,5	13	6,5
SC-2	7	15	5
SC-2	7	15	7
SC-2	8	14	4
SC-2	8	14	6
SC-2	8	15	5
SC-2	8	15	6
SC-2	8	15	8
SC-2	8	16	6
SC-2	8	16	8
SC-2	8	18	6
SC-2	8	18	8
SC-2	9	16	4

SC-2	9	16	7
SC-2	9	17	6
SC-2	10	16	4
SC-2	10	16	5
SC-2	10	16	6
SC-2	10	18	6
SC-2	10	18	8
SC-2	10	20	7
SC-2	10	20	8
SC-2	10	22	8
SC-2	10	25	10
SC-2	10	26	8
SC-2	10	28	10
SC-2	11	20,5	6
SC-2	11,5	16	2,5
SC-2	12	18	2,5
SC-2	12	18	4
SC-2	12	18	5
SC-2	12	18	6
SC-2	12	20	5
SC-2	12	20	5,5
SC-2	12	20	6
SC-2	12	20	8
SC-2	12	22	6
SC-2	12	22	7
SC-2	12	22	8
SC-2	12	24	8
SC-2	12	25	8
SC-2	12	26	10
SC-2	12	28	10
SC-2	12	32	10
SC-2	12,5	20	8
SC-2	13	25	8

SC-2	14	20	2,55
SC-2	14	20	4
SC-2	14	20	5
SC-2	14	20	6
SC-2	14	22	5
SC-2	14	22	6
SC-2	14	22	8
SC-2	14	24	5
SC-2	14	24	6
SC-2	14	24	8
SC-2	14	25	8
SC-2	14	28	8
SC-2	14	28	10
SC-2	15	22	8
SC-2	15	25	8
SC-2	15	26	6
SC-2	15	26	8
SC-2	15	28	8
SC-2	15	28	10
SC-2	15	30	6
SC-2	15	30	8
SC-2	15	30	10
SC-2	16	22	3
SC-2	16	22	5
SC-2	16	22	6
SC-2	16	22	10
SC-2	16	24	6
SC-2	16	25	5
SC-2	16	26	6
SC-2	16	26	7
SC-2	16	26	8
SC-2	16	28	6
SC-2	16	32	10

SC-2	17	25	4
SC-2	18	24	4
SC-2	18	25	5
SC-2	18	26	4
SC-2	18	26	5
SC-2	18	26	6
SC-2	18	28	8
SC-2	18	28,2	9
SC-2	18	30	6
SC-2	18	30	8
SC-2	18	30	8,5
SC-2	18	30	9
SC-2	18	30	10
SC-2	18	32	7
SC-2	19	25	6
SC-2	20	25	3
SC-2	20	26	5,5
SC-2	20	27	6
SC-2	20	28	4
SC-2	20	28	5
SC-2	20	28	5,8
SC-2	20	28	6
SC-2	20	28	8
SC-2	20	30	5
SC-2	20	30	6
SC-2	20	30	8
SC-2	20	30	10
SC-2	20	32	5
SC-2	20	31	6
SC-2	20	32	6
SC-2	20	32	8
SC-2	20	35	10
SC-2	20	35	12

SC-2	20	36	8
SC-2	20	36	10
SC-2	20	38	8
SC-2	20	40	10
SC-2	20	40	12
SC-2	22	30	5
SC-2	22	30	6
SC-2	22	30	7
SC-2	22	30	8
SC-2	22	32	5
SC-2	22	32	7
SC-2	22	32	8
SC-2	22	32	10
SC-2	22	34	8,4
SC-2	22	38	10
SC-2	22	40	8
SC-2	22	40	10
SC-2	22	42	10
SC-2	24	30	6
SC-2	24	32	5,5
SC-2	24	35	6
SC-2	24,5	30	4,5
SC-2	24,5	31,8	4,5
SC-2	25	30	5
SC-2	25	32	4
SC-2	25	32	5
SC-2	25	32	7
SC-2	25	33	5
SC-2	25	33	5,8
SC-2	25	33	6
SC-2	25	33	6,5
SC-2	25	33	7
SC-2	25	35	5

SC-2	25	35	6
SC-2	25	35	7
SC-2	25	35	8
SC-2	25	35	10
SC-2	25	37	7
SC-2	25	38	6
SC-2	25	38	7
SC-2	25	38	8
SC-2	25	38	10
SC-2	25	40	8
SC-2	25	40	10
SC-2	25	45	10
SC-2	25	50	12
SC-2	27	35	4
SC-2	27	38	6
SC-2	28	34,5	4
SC-2	28	35	4
SC-2	28	35	6
SC-2	28	35	7
SC-2	28	35	8
SC-2	28	35	10
SC-2	28	36	4
SC-2	28	36	6
SC-2	28	38	8
SC-2	28	38	10
SC-2	28	40	6
SC-2	28	40	10
SC-2	28	42	8
SC-2	28	43	10
SC-2	28	48	9
SC-2	28	48	10
SC-2	28	48	12
SC-2	30	38	6

SC-2	30	38	8
SC-2	30	38	10
SC-2	30	40	6
SC-2	30	40	7
SC-2	30	40	8
SC-2	30	40	10
SC-2	30	42	8
SC-2	30	42	10
SC-2	30	45	10
SC-2	30	50	10
SC-2	30	50	12
SC-2	31,1	57,15	12,7
SC-2	31,5	41,5	6
SC-2	32	40	5
SC-2	32	40	7
SC-2	32	40	8
SC-2	32	42	7
SC-2	32	42	11
SC-2	32	44	9,5
SC-2	32	45	8
SC-2	32	45	10
SC-2	32	47	10
SC-2	32	48	10
SC-2	32	50	10
SC-2	32	52	10
SC-2	32	52	12
SC-2	34	41	8
SC-2	34	43,5	6
SC-2	35	42	10
SC-2	35	42	12
SC-2	35	43	6
SC-2	35	45	6
SC-2	35	45	7



SC-2	35	45	8
SC-2	35	45	10
SC-2	35	47	6
SC-2	35	48	8
SC-2	35	50	6
SC-2	35	50	7
SC-2	35	50	8
SC-2	35	50	9
SC-2	35	50	10
SC-2	35	52	12
SC-2	35	55	10
SC-2	35	55	12
SC-2	35,5	43	8
SC-2	36	43	8
SC-2	36	46	6
SC-2	36	46	7
SC-2	36	46	8
SC-2	36	46	10
SC-2	36	50	8
SC-2	36	51	10
SC-2	38	48	10
SC-2	38	50	8
SC-2	38	50	10
SC-2	38	55	10
SC-2	38	58	10
SC-2	40	48	6
SC-2	40	48	8
SC-2	40	50	5
SC-2	40	50	7
SC-2	40	50	7,8
SC-2	40	50	8
SC-2	40	50	10
SC-2	40	52	6

SC-2	40	52	9
SC-2	40	52	12
SC-2	40	55	7
SC-2	40	55	10
SC-2	40	56	10
SC-2	40	58	8
SC-2	40	58	10
SC-2	40	60	10
SC-2	40	60	12
SC-2	40	62	10
SC-2	40	62	12
SC-2	40	65	10
SC-2	40	65	12
SC-2	42	48	6
SC-2	42	50	3,25
SC-2	42	50	5
SC-2	42	50	8
SC-2	42	50	12
SC-2	42	52	8
SC-2	42	52	10
SC-2	42	55	10
SC-2	42	60	10
SC-2	42	62	12
SC-2	42	65	10
SC-2	43	63	10
SC-2	43	63	12
SC-2	44	60	12,7
SC-2	44,45	53,97	9,6
SC-2	44,5	54	6,5
SC-2	45	53	7
SC-2	45	53	8
SC-2	45	55	6
SC-2	45	55	10

SC-2	45	55,5	7
SC-2	45	57	6
SC-2	45	58	10
SC-2	45	60	10
SC-2	45	62	10
SC-2	45	63	10
SC-2	45	63	12
SC-2	45	65	10
SC-2	45	65	12
SC-2	45	70	12
SC-2	46	55	7
SC-2	46	55	8
SC-2	46	70	12
SC-2	47	56	9
SC-2	47	57	9
SC-2	48	58	10
SC-2	50	58	8
SC-2	50	60	6
SC-2	50	60	7
SC-2	50	60	8
SC-2	50	60	10
SC-2	50	60	12
SC-2	50	62	6
SC-2	50	62	7,8
SC-2	50	62	12
SC-2	50	63	6
SC-2	50	63	8
SC-2	50	63	9
SC-2	50	63	10
SC-2	50	65	8
SC-2	50	65	9
SC-2	50	65	10
SC-2	50	65	12

SC-2	50	68	10
SC-2	50	68	12
SC-2	50	70	8
SC-2	50	70	10
SC-2	50	70	12
SC-2	50	74	15
SC-2	51	63	9,5
SC-2	52	60	8
SC-2	52	62	6
SC-2	52	62	12
SC-2	53	63	6
SC-2	53	63	7
SC-2	53	63	8
SC-2	53	63	12
SC-2	53	64	7
SC-2	53	65	6
SC-2	53	65	8
SC-2	55	65	5
SC-2	55	65	7,3
SC-2	55	65	10
SC-2	55	65	12
SC-2	55	68	10
SC-2	55	70	10
SC-2	55	70	12
SC-2	55	72	10
SC-2	55	75	12
SC-2	55	78	10
SC-2	55	80	12
SC-2	55	80	15
SC-2	55	85	10
SC-2	56	70	12
SC-2	56	71	10
SC-2	56	71	12,5

SC-2	56	76	12
SC-2	57	72	12
SC-2	60	68	7
SC-2	60	70	6
SC-2	60	70	7
SC-2	60	70	10
SC-2	60	70	12
SC-2	60	72	10
SC-2	60	72	12
SC-2	60	75	8
SC-2	60	75	10
SC-2	60	75	12
SC-2	60	80	10
SC-2	60	80	12
SC-2	60	85	12
SC-2	62	75	8
SC-2	63	83	12
SC-2	64	76,5	9,8
SC-2	64	80	8
SC-2	65	75	7
SC-2	65	75	10
SC-2	65	75	12
SC-2	65	80	10
SC-2	65	80	12
SC-2	65	85	10
SC-2	65	85	12
SC-2	65	90	13
SC-2	68	80	8,5
SC-2	68	80	10
SC-2	68	80	15
SC-2	70	78	12
SC-2	70	80	6
SC-2	70	80	7

SC-2	70	80	8
SC-2	70	80	10
SC-2	70	80	12
SC-2	70	82	8,7
SC-2	70	82	10
SC-2	70	83	10
SC-2	70	85	8
SC-2	70	85	10
SC-2	70	85	12
SC-2	70	90	10
SC-2	70	90	12
SC-2	70	90	15
SC-2	73	88	13
SC-2	75	85	7
SC-2	75	85	12
SC-2	75	88	10
SC-2	75	90	10
SC-2	75	90	12
SC-2	75	95	12
SC-2	75	96	12
SC-2	75	100	12
SC-2	75	100	18
SC-2	76	91	14
SC-2	78	98	12,7
SC-2	80	90	6
SC-2	80	90	7
SC-2	80	90	10
SC-2	80	90	12
SC-2	80	90	15
SC-2	80	95	8
SC-2	80	95	9
SC-2	80	95	10
SC-2	80	95	12

SC-2	80	100	10
SC-2	80	100	12
SC-2	80	100	15
SC-2	80	105	15
SC-2	82,5	95,25	9,5
SC-2	85	95	9
SC-2	85	95	10
SC-2	85	97	9
SC-2	85	100	8
SC-2	85	100	10
SC-2	85	100	12
SC-2	85	105	12
SC-2	85	110	12
SC-2	85	110	18
SC-2	86,5	101	13,5
SC-2	88	100	8,5
SC-2	88	108,5	15,5
SC-2	89	104	13
SC-2	90	100	8
SC-2	90	100	10
SC-2	90	100	12
SC-2	90	105	10
SC-2	90	105	12
SC-2	90	110	10
SC-2	90	110	12
SC-2	90	110	13
SC-2	90	110	15
SC-2	90	115	12
SC-2	90	120	15
SC-2	95	110	9
SC-2	95	110	10
SC-2	95	110	12
SC-2	95	115	12

SC-2	95	115	15
SC-2	95	120	12
SC-2	100	110	5
SC-2	100	110	8
SC-2	100	112	8
SC-2	100	115	10
SC-2	100	115	12
SC-2	100	120	12
SC-2	100	120	15
SC-2	100	125	12
SC-2	100	125	15
SC-2	100	130	15
SC-2	100	130	18
SC-2	105	120	8
SC-2	105	125	8
SC-2	105	125	8,25
SC-2	105	125	12
SC-2	105	130	15
SC-2	105	130	18
SC-2	110	120	8
SC-2	110	125	10
SC-2	110	125	12
SC-2	110	130	10
SC-2	110	130	13
SC-2	110	130	15
SC-2	110	135	18
SC-2	110	140	18
SC-2	113	128	8
SC-2	114	130	16
SC-2	115	125	8
SC-2	115	125	12
SC-2	115	125	15
SC-2	115	130	10



SC-2	115	135	15
SC-2	115	140	18
SC-2	120	130	7
SC-2	120	132	10
SC-2	120	135	10
SC-2	120	135	15
SC-2	120	140	10
SC-2	120	140	12
SC-2	120	140	13
SC-2	120	140	15
SC-2	120	145	18
SC-2	120	150	12
SC-2	120	150	15
SC-2	120	150	18
SC-2	125	140	11
SC-2	125	145	10
SC-2	125	145	15
SC-2	125	150	18
SC-2	125	150	22
SC-2	125	155	18
SC-2	130	140	8
SC-2	130	145	15
SC-2	130	150	13
SC-2	130	150	15
SC-2	130	160	18
SC-2	135	150	15
SC-2	135	165	15
SC-2	140	150	6
SC-2	140	150	12,7
SC-2	140	160	8
SC-2	140	160	10
SC-2	140	160	13
SC-2	140	160	14,5

SC-2	140	160	15
SC-2	140	165	18
SC-2	140	170	18
SC-2	145	160	8
SC-2	145	170	18
SC-2	145	175	18
SC-2	150	170	15
SC-2	150	180	15
SC-2	150	180	18
SC-2	152,4	165,1	15
SC-2	160	175	12
SC-2	160	180	15
SC-2	160	190	22
SC-2	165	185	15
SC-2	170	190	15
SC-2	170	200	15
SC-2	170	200	22
SC-2	175	205	15
SC-2	175	215	20
SC-2	180	200	15
SC-2	180	205	15
SC-2	180	210	22
SC-2	185	195	12
SC-2	187,32	203,2	7,93
SC-2	190	210	15
SC-2	190	215	15
SC-2	190	215	16
SC-2	190	220	25
SC-2	200	220	15
SC-2	200	230	18
SC-2	200	230	22
SC-2	200	235	20
SC-2	204	224	12

SC-2	210	230	15
SC-2	210	240	18
SC-2	212	237	18
SC-2	215	245	18
SC-2	220	250	15
SC-2	220	250	20
SC-2	225	250	15
SC-2	230	250	12
SC-2	230	250	15
SC-2	230	260	18
SC-2	235	255	12
SC-2	240	260	16
SC-2	240	265	18
SC-2	240	270	18
SC-2	245	275	18
SC-2	250	270	15
SC-2	250	280	18
SC-2	250	280	22